



AGENDA OF THE ROAD SAFETY TASK
FORCE
CITY OF BIRCHWOOD VILLAGE
WASHINGTON COUNTY, MINNESOTA
June 6th, 2024
7:00 P.M.

CALL TO ORDER

WELCOME

APPROVE AGENDA

PUBLIC FORUM

REGULAR AGENDA

1. Review/approve minutes from May 2nd meeting* (pp. 2-4)
2. Proposal for 20 MPH speed limit on all streets in Birchwood
 - a. Currently Hall & Cedar are 25 MPH.
 - b. Present Washington County Police data from traffic study* (pp. 5-6)
 - c. Present MDT information on non-commercial roads.
3. Proposal for stop signs and crosswalks in unsafe areas.
 - a. Crosswalk and stop signs at Wildwood Ave and Owl Street.
 - b. Crosswalk at Wildwood Ave and Gotto St.
4. Allow for public response to proposals to road safety to present to the city council at the next council meeting.
5. Document road traffic statistics, proposals to the city council, and cost to implement traffic safety proposals.
6. Present to city council at next meeting.

ADJOURN

* Denotes items that have supporting documentation

City of Birchwood Village
Road Safety Task Force
5/2/2024 Meeting Minutes

- Meeting opened at 7:06 PM
- Present at the meeting
 - Ron Malles, Cora Hankins, Margaret Ford & Art Arsenault
 - Not present: none
- Meeting Minutes from 4/11/24 meeting approved without corrections
- Raw data from the last speed study on Wildwood Ave from Washington County has not yet been received.
- Task Force agreed to add an Open Forum to the June 6, 2024 meeting between 7 and 8 PM. Two proposals to open for decision in the forum include:
 - Proposal 1: The City of Birchwood adopting a city wide 20 MPH speed limit.
 - Nine signs would require new signage as well as one new sign is being recommended on Iris Street (Northeast bound after Jay Path)
 - Proposal 2:
 - 2.a) The addition of a Crosswalk with both new painted Crosswalk and two(2) new Stop signs on Wildwood Ave and Owl St. (Birch Easement)
 - This location is important for year round community safety because it serves both White Bear Lake Schools and Mahtomedi Schools as a bus stop and is access area for residents to the Birch Beach Easement.
 - 2.b) The addition of a Crosswalk with both new painted Crosswalk and two(2) new "Stop for Ped Here signs on Wildwood Ave and Grotto St.
 - This location is also important for year round community safety because residents use Grotto Street/Path to access Tighe-Schmitz Park, the Dellwood Easement and/or Kay Beach Easement.
 - 2.c) The addition of one(1) Stop sign on Southeast bound Wildwood Ave. near lots 368 and 400 (@ Lake Ave & Wildwood Ave. intersection)
 - This new Stop sign is being recommended because of limited sight lines and residents safety.
 - Cora to coordinate with Rebecca the Open Forum notification/announcement.
- Still open is a request for at least two additional speed studies from Washington County at or near 509 Wildwood Ave as well as 600 Hall Ave in both directions. Other locations might be added as needed.
- Next Meeting w/ Open Forum set for Thursday June 6, 2024 @ 7:00PM
- Meeting adjourned 8:37 PM

Prepared & Submitted by: Art Arsenault on 5/9/24

Legend

- 25 MPH Signs (9 currently)
- 20 MPH Signs (12 currently)
- Proposed Stop Signs (4)
- Proposed Crosswalk painted pavement (2)
- P Proposed 20 MPH Sign (1)
- Proposed Yield Sign (2)

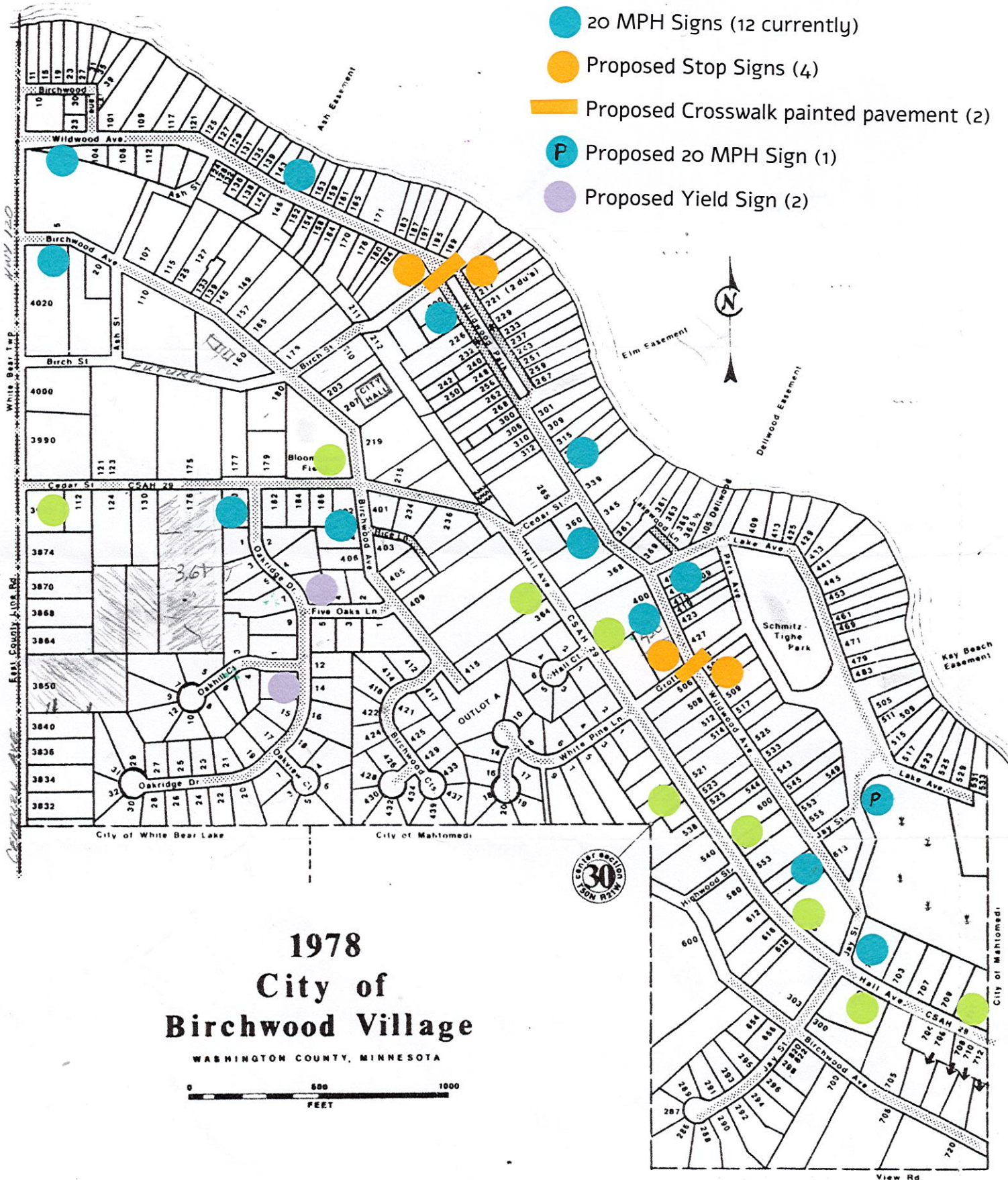

1978 City of Birchwood Village

WASHINGTON COUNTY, MINNESOTA

0 500 1000
FEET

City of Birchwood Village – Road Safety Tack Force

Item	Description	Cost		Sub Totals	
		Material	Labor	Ron & Art	Contracted
1	Replace 9 - 25 MPH Speed Limit signs to 20 MPH. 24" x 30" 3M Reflective from Highway Traffic Supply (Amazon)	9 @ \$55.00 = \$495	9 @ 1 hour		
			Ron & Art - \$0	\$495.00	
			Sub Contracted 9hrs @ \$50 = \$450		\$945.00
2	Addition of 2 new pedestrian crosswalks with signage (2 signs per crosswalk) on Wildwood Ave @ Birch Beach/Owl and Grotto				
	Paint Crosswalk on the pavement	Labor & Material Sub-contacted estimate on Blain, MN 2014 booklet 2 @ \$300			\$600.00
	Install 4 Sign Posts 8'-0" U Channel post and Hardware (Amazon)	4 signs @ \$100 = \$400			
	Install 4 Signs (Stop Pedestrian Crossing) 24"x30" Reflective from Highway Traffic Supply (Amazon)	4 Post & Hardware @ \$100 = \$400	Ron & Art - \$0 Sub Contracted 8 @ \$50 = \$400	\$800.00	\$1,200.00
3	Install 1 new 20 MPH sign with post on Iris Street between Wildwood Ave & Lake Ave	\$55.00 Sign \$100.00 Post & Hardware	Ron & Art - \$0	\$155.00	
			Sub Contracted 2 @ \$50 = \$100		\$255.00
Item #4 is NOT recommended at this point in time and would have to be reviewed after Items #1 & #2 have been completed					
4	Addition of 4 new Solar Powered Radar Speed signs. Two (2) signs on Wildwood Ave and two (2) on Hall Ave. LED Lighting Solutions	4 signs @ \$4053.99 = \$16215.96 Shipping = \$410 4 posts @ \$150 = \$600			\$18,388.71

Road Safety task Force recommendation is to approve and authorize funds to complete Items 1,2 & 3.

Using Ron Malles and Art Arsenault's labor at no cost	\$1,450.00
Paint Crosswalk on the pavement	\$600.00
TAX (6.75%) :	\$97.88
Unknown factors (15%) :	\$217.50
Total not to exceed :	\$2,365.38

Using contacted labor for all three (3) items	\$2,400.00
TAX (6.75%) :	\$162.00
Unknown factors (15%) :	\$360.00
Total not to exceed :	\$2,922.00

Attached you will find the results of the speed trailer located at Birchwood 164 Wildwood Eastbound. The areas was monitored from 10/18 – 10/25. I spoke with Sheriff Pearson and the results show that the 50th percentile of travelers were at 21 miles per hour. The 25th percentile of travelers were at 17 miles per hour, and the 85th percentile of travelers were at 25 miles per hour. The speed limit there is 20 mph.

For the period of 10/18/23 12:00:00 AM to 10/23/23 02:00:01 PM, 953 vehicles passed at below 19 mph. 1564 passed between 19 and 27 mph, and 33 passed between 28-36 mph.

For the period of 10/23/23 12:00:00 AM to 10/25/23 02:30:00 PM, 419 vehicles passed below 19 mph. 676 vehicles passed between 19-27 mph. 15 vehicles passed between 28-36 mph.

Attached you will find the more detailed results for your review, by week.

Thank you,

Rebecca Kellen

Highest Speeds Summary Report

Title/Location: Bwood164ebwd
Sign Address: 20401123300003

Measurement Period: 10/23/23 12:00:00 AM to 10/25/23 02:30:00 PM
Reporting Period: 10/23/23 12:00:00 AM to 10/25/23 02:30:00 PM

Total number of vehicles: 1110
Posted Speed Limit: 20 MPH
25th Percentile Speed: 17 MPH
Total Vehicles For:
Below 19: 419
37 - 45: 0
64 - 72: 0
Above 91: 0

Lowest Log Speed Setting: 10 MPH
Average Speed: 19 MPH
50th Percentile Speed: 21 MPH

19 - 27: 676
46 - 54: 0
73 - 81: 0

Highest Log Speed Setting: 100 MPH
85th Percentile Speed: 25 MPH

28 - 36: 15
55 - 63: 0
82 - 90: 0